

# Mosquitera enrollable MOTORIZADA 130

## Ficha técnica

### Medidas recomendadas

Alto máximo recomendado	4,50 m
Ancho máximo recomendado	5,00 m
Ancho mínimo	0,60 m

### Secciones cabezal

instalación al frente/ pose de face

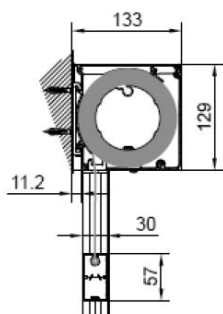

vista posterior/vue arrière

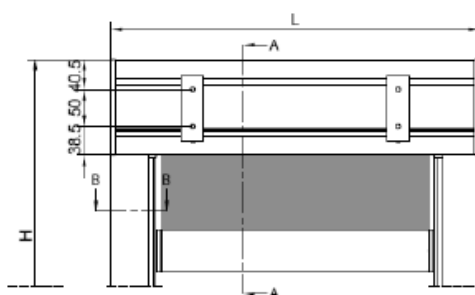

instalación al techo/ pose plafond

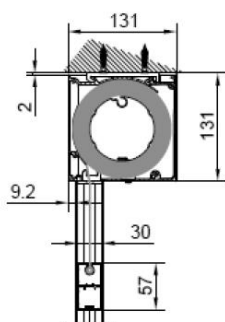

vista superior/ vue supérieure

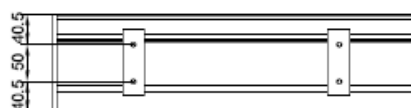

### Secciones guías laterales

sujeción lateral/pose laterale

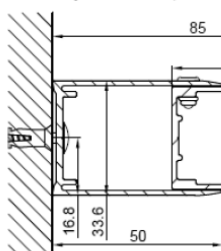

sujeción lateral/pose laterale

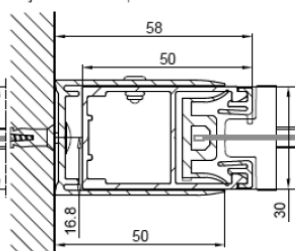

sujeción al frente/ pose de face

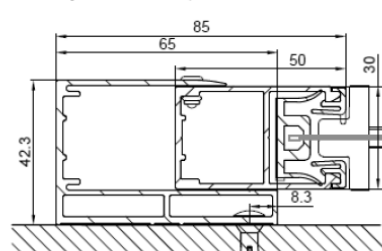

sujeción al frente/ pose de face

